

PROJEÇÃO UNIVERSAL TRANSVERSA DE MERCATOR	
VERTICE DE REFERENCIA	
CABECEIRA-1	
LATITUDE: 03°02'18.6400" S	
LONGITUDE: 60°03'42.6440" W	
DATA	JAN/2004
DECLINAÇÃO MAGNÉTICA (DM)	14°03'
VARIACÃO ANUAL	08'
CONVERGENCIA MERIDIANA (CM)	
-0921.1865"	
FATOR DE ESCALA	1:006268897

ORIGEM DAS COORDENADAS:
INSTITUTO DE CARTOGRAFIA AERONAUTICA - ICA - (DADOS DA CABECEIRA 11 DE 01/2004)

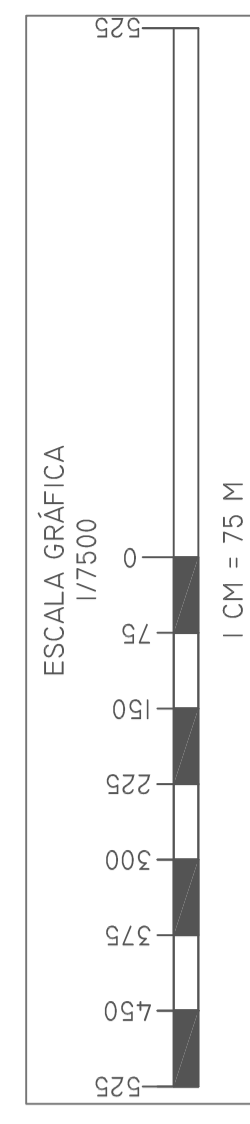

LEGENDA :

- ÁREA MILITAR
- ÁREA CIVIL

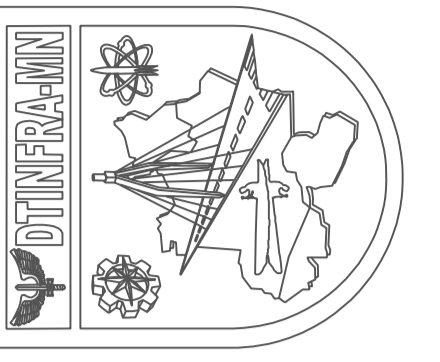

COMANDO DA AERONÁUTICA
DIRETORIA DE INGENHARIA DA AERONÁUTICA - DIRPRA
COORDENADORIA DE AERONÁUTICA - COORPRA
SEÇÃO DE MANUSEIO DE PLANOS
APROVO

FELIPE SANTANA LOPES NAIFF DE ABREU
CHEFE DO DEPARTAMENTO

REZONAMENTO CIVIL-MILITAR
DO
AEROPORTO DE EDUARDO GOMES - AM

COMANDANTE
DEPARTAMENTO DE INGENHARIA DA AERONÁUTICA
CORPO DE ENGENHEIROS MILITARES
ESCALA
DATA
REVISÃO

RESP. TEC.º F.º : FELIPE SANTANA LOPES NAIFF DE ABREU
ASS. TEC.º :
ASS. ESC.º :
EMISSÃO: 11/07/2004
REVISÃO: 12/08/2004
REVISÃO: 12/28/2004
REVISÃO: 12/28/2004

AM/003/XXX/2019/67290

SIGNATURA AUTOMÁTICA FOR

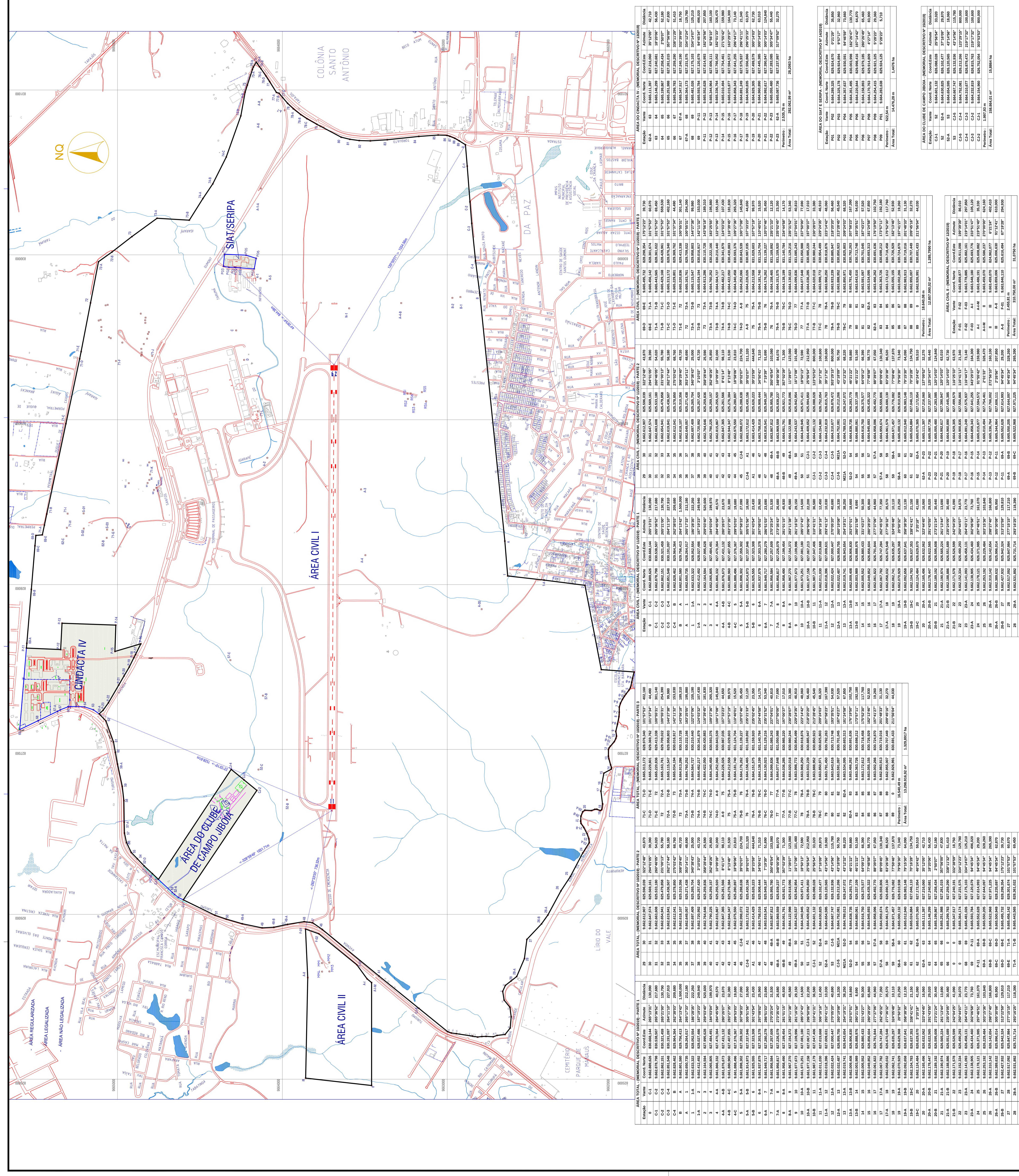

Etiqueta	Vértice	Coord. Norte	Coord. Leste	Distância
0	C-1	9.665.013.117	828.608.838	43.770
1	C-1	9.665.013.117	828.608.838	43.770
2	C-1	9.665.013.117	828.608.838	43.770
3	C-1	9.665.013.117	828.608.838	43.770
4	C-1	9.665.013.117	828.608.838	43.770
5	C-1	9.665.013.117	828.608.838	43.770
6	C-1	9.665.013.117	828.608.838	43.770
7	C-1	9.665.013.117	828.608.838	43.770
8	C-1	9.665.013.117	828.608.838	43.770
9	C-1	9.665.013.117	828.608.838	43.770
10	C-1	9.665.013.117	828.608.838	43.770
11	C-1	9.665.013.117	828.608.838	43.770
12	C-1	9.665.013.117	828.608.838	43.770
13	C-1	9.665.013.117	828.608.838	43.770
14	C-1	9.665.013.117	828.608.838	43.770
15	C-1	9.665.013.117	828.608.838	43.770
16	C-1	9.665.013.117	828.608.838	43.770
17	C-1	9.665.013.117	828.608.838	43.770
18	C-1	9.665.013.117	828.608.838	43.770
19	C-1	9.665.013.117	828.608.838	43.770
20	C-1	9.665.013.117	828.608.838	43.770
21	C-1	9.665.013.117	828.608.838	43.770
22	C-1	9.665.013.117	828.608.838	43.770
23	C-1	9.665.013.117	828.608.838	43.770
24	C-1	9.665.013.117	828.608.838	43.770
25	C-1	9.665.013.117	828.608.838	43.770
26	C-1	9.665.013.117	828.608.838	43.770
27	C-1	9.665.013.117	828.608.838	43.770
28	C-1	9.665.013.117	828.608.838	43.770
29	C-1	9.665.013.117	828.608.838	43.770
30	C-1	9.665.013.117	828.608.838	43.770
31	C-1	9.665.013.117	828.608.838	43.770
32	C-1	9.665.013.117	828.608.838	43.770
33	C-1	9.665.013.117	828.608.838	43.770
34	C-1	9.665.013.117	828.608.838	43.770
35	C-1	9.665.013.117	828.608.838	43.770
36	C-1	9.665.013.117	828.608.838	43.770
37	C-1	9.665.013.117	828.608.838	43.770
38	C-1	9.665.013.117	828.608.838	43.770
39	C-1	9.665.013.117	828.608.838	43.770
40	C-1	9.665.013.117	828.608.838	43.770
41	C-1	9.665.013.117	828.608.838	43.770
42	C-1	9.665.013.117	828.608.838	43.770
43	C-1	9.665.013.117	828.608.838	43.770
44	C-1	9.665.013.117	828.608.838	43.770
45	C-1	9.665.013.117	828.608.838	43.770
46	C-1	9.665.013.117	828.608.838	43.770
47	C-1	9.665.013.117	828.608.838	43.770
48	C-1	9.665.013.117	828.608.838	43.770
49	C-1	9.665.013.117	828.608.838	43.770
50	C-1	9.665.013.117	828.608.838	43.770
51	C-1	9.665.013.117	828.608.838	43.770
52	C-1	9.665.013.117	828.608.838	43.770
53	C-1	9.665.013.117	828.608.838	43.770
54	C-1	9.665.013.117	828.608.838	43.770
55	C-1	9.665.013.117	828.608.838	43.770
56	C-1	9.665.013.117	828.608.838	43.770
57	C-1	9.665.013.117	828.608.838	43.770
58	C-1	9.665.013.117	828.608.838	43.770
59	C-1	9.665.013.117	828.608.838	43.770
60	C-1	9.665.013.117	828.608.838	43.770
61	C-1	9.665.013.117	828.608.838	43.770
62	C-1	9.665.013.117	828.608.838	43.770
63	C-1	9.665.013.117	828.608.838	43.770
64	C-1	9.665.013.117	828.608.838	43.770
65	C-1	9.665.013.117	828.608.838	43.770
66	C-1	9.665.013.117	828.608.838	43.770
67	C-1	9.665.013.117	828.608.838	43.770
68	C-1	9.665.013.117	828.608.838	43.770
69	C-1	9.665.013.117	828.608.838	43.770
70	C-1	9.665.013.117	828.608.838	43.770
71	C-1	9.665.013.117	828.608.838	43.770
72	C-1	9.665.013.117	828.608.838	43.770
73	C-1	9.665.013.117	828.608.838	43.770
74	C-1	9.665.013.117	828.608.838	43.770
75	C-1	9.665.013.117	828.608.838	43.770
76	C-1	9.665.013.117	828.608.838	43.770
77	C-1	9.665.013.117	828.608.838	43.770
78	C-1	9.665.013.117	828.608.838	43.770
79	C-1	9.665.013.117	828.608.838	43.770
80	C-1	9.665.013.117	828.608.838	43.770
81	C-1	9.665.013.117	828.608.838	43.770
82	C-1	9.665.013.117	828.608.838	43.770
83	C-1	9.665.013.117	828.608.838	43.770
84	C-1	9.665.013.117	828.608.838	43.770
85	C-1	9.665.013.117	828.608.838	43.770
86	C-1	9.665.013.117	828.608.838	43.770
87	C-1	9.665.013.117	828.608.838	43.770
88	C-1	9.665.013.117	828.608.838	43.770
89	C-1	9.665.013.117	828.608.838	43.770
90	C-1	9.665.013.117	828.608.838	43.770
91	C-1	9.665.013.117	828.608.838	43.770
92	C-1	9.665.013.117	828.608.838	43.770
93	C-1	9.665.013.117	828.608.838	43.770
94	C-1	9.665.013.117	828.608.838	43.770
95	C-1	9.665.013.117	828.608.838	43.770
96	C-1	9.665.013.117	828.608.838	43.770
97	C-1	9.665.013.117	828.608.838	43.770
98	C-1	9.665.013.117	828.608.838	43.770
99	C-1	9.665.013.117	828.608.838	43.770
100	C-1	9.665.013.117	828.608.838	43.770