

Obs.: As medidas são apenas de referência, devendo ser confirmadas antes da execução

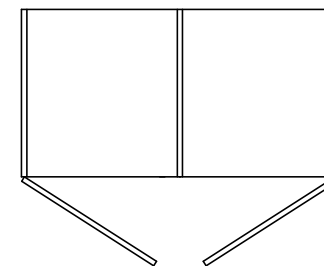

- * ARMÁRIOS COM CHAVES
- * PUXADORES EM PERFIL DE ALUMÍNIO COM TAMPA PARA ACABAMENTO LATERAL
- * ARMÁRIOS SUSPENSOS COM 10 CM DE ALTURA

Módulo A
quantidade: 1
MDF 15 mm

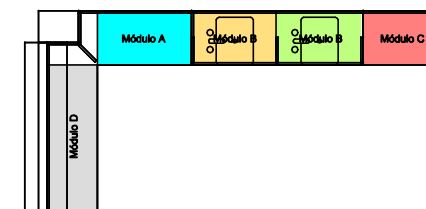

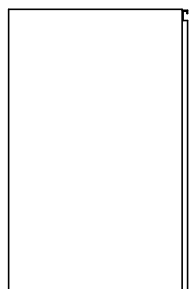
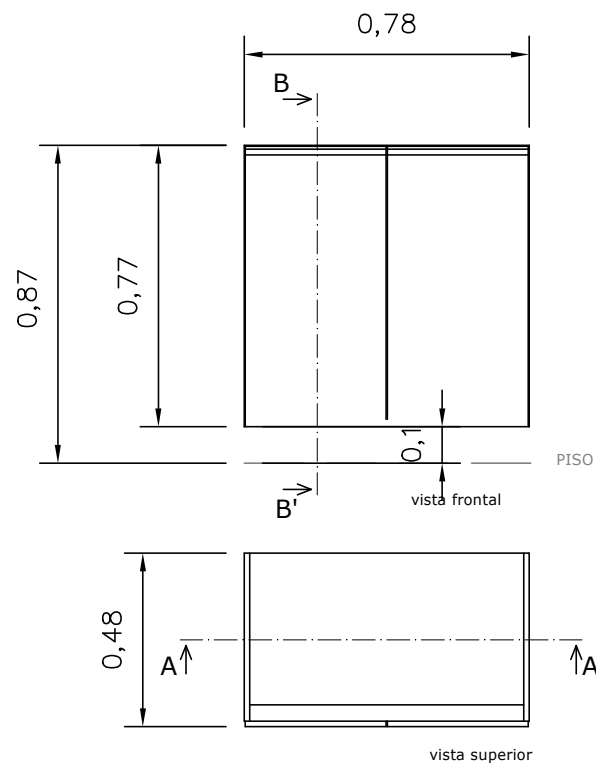

vista lateral

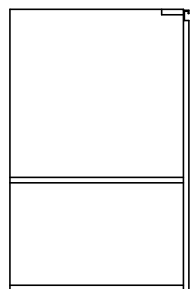

corde BB'



corde AA'

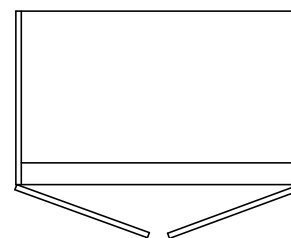

vista superior indicando sentido de abertura das portas

Obs.: As medidas são apenas de referência, devendo ser confirmadas antes da execução

- * ARMÁRIOS COM CHAVES
- * PUXADORES EM PERFIL DE ALUMÍNIO COM TAMPA PARA ACABAMENTO LATERAL
- * ARMÁRIOS SUSPENSOS COM 10 CM DE ALTURA

Módulo B
quantidade: 2
MDF 15 mm

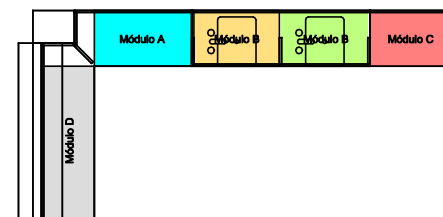

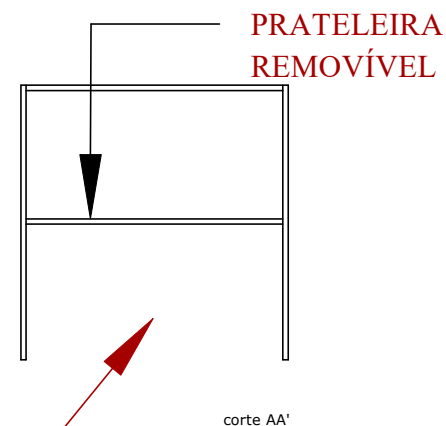
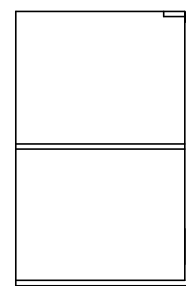
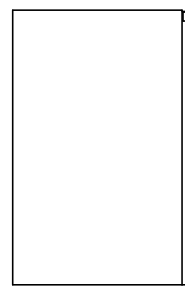
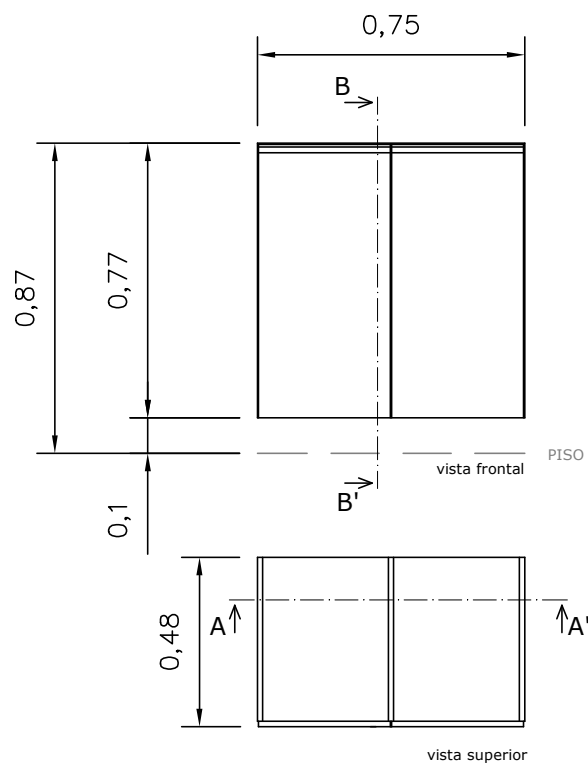

**ABERTO PARA ACESSO
À CAIXA DE GORDURA**

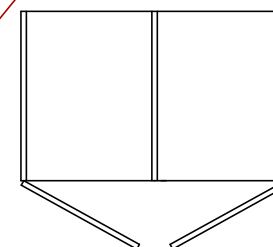

- * ARMÁRIOS COM CHAVES
- * PUXADORES EM PERFIL DE ALUMÍNIO COM TAMPA PARA ACABAMENTO LATERAL
- * ARMÁRIOS SUSPENSOS COM 10 CM DE ALTURA

Módulo C
quantidade: 1
MDF 15 mm

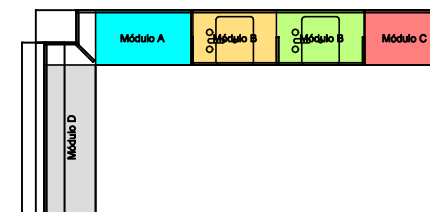

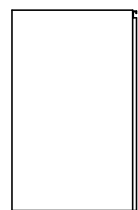
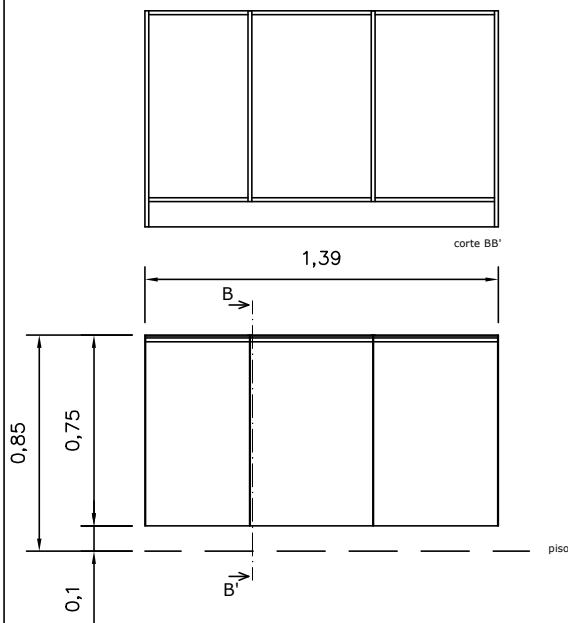

vista lateral

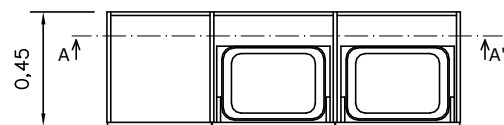
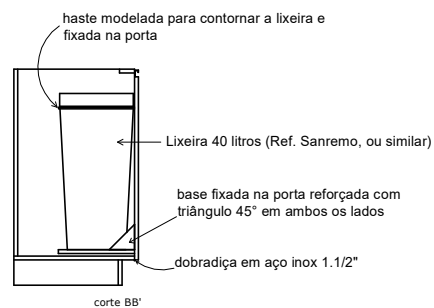

Obs.: As medidas são apenas de referência, devendo ser confirmadas antes da execução

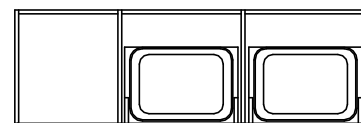

vista superior indicando sentido de abertura das portas

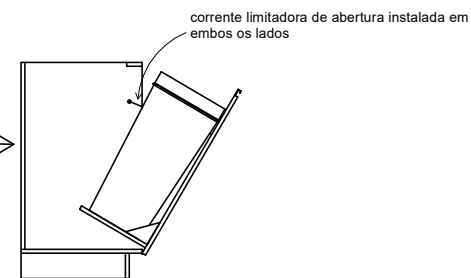

Módulo D
quantidade: 1
MDF 15 mm

- * ARMÁRIOS COM CHAVES
- * PUXADORES EM PERFIL DE ALUMÍNIO COM TAMPA PARA ACABAMENTO LATERAL
- * ARMÁRIOS SUSPENSOS COM 10 CM DE ALTURA